



## ICS - Upper Level

### Seminar and Conference Area

Rooms C3-C10 can be separated into as many as 33 conference and seminar rooms. A flexible partitioning system can divide the largest conference rooms into six individual spaces. A control system makes it possible to present specific content to each of these partial rooms, and additional technical equipment is available when needed.

The individual rooms can accommodate between 12 and 440 people. From the gallery of the seminar and conference area, guests can also enjoy a grand view of the Messepiazza.

In addition, suitable office space and working areas are available for smaller meetings. All of the rooms in this area have natural light, but can also be darkened if required.





## ICS - Upper Level

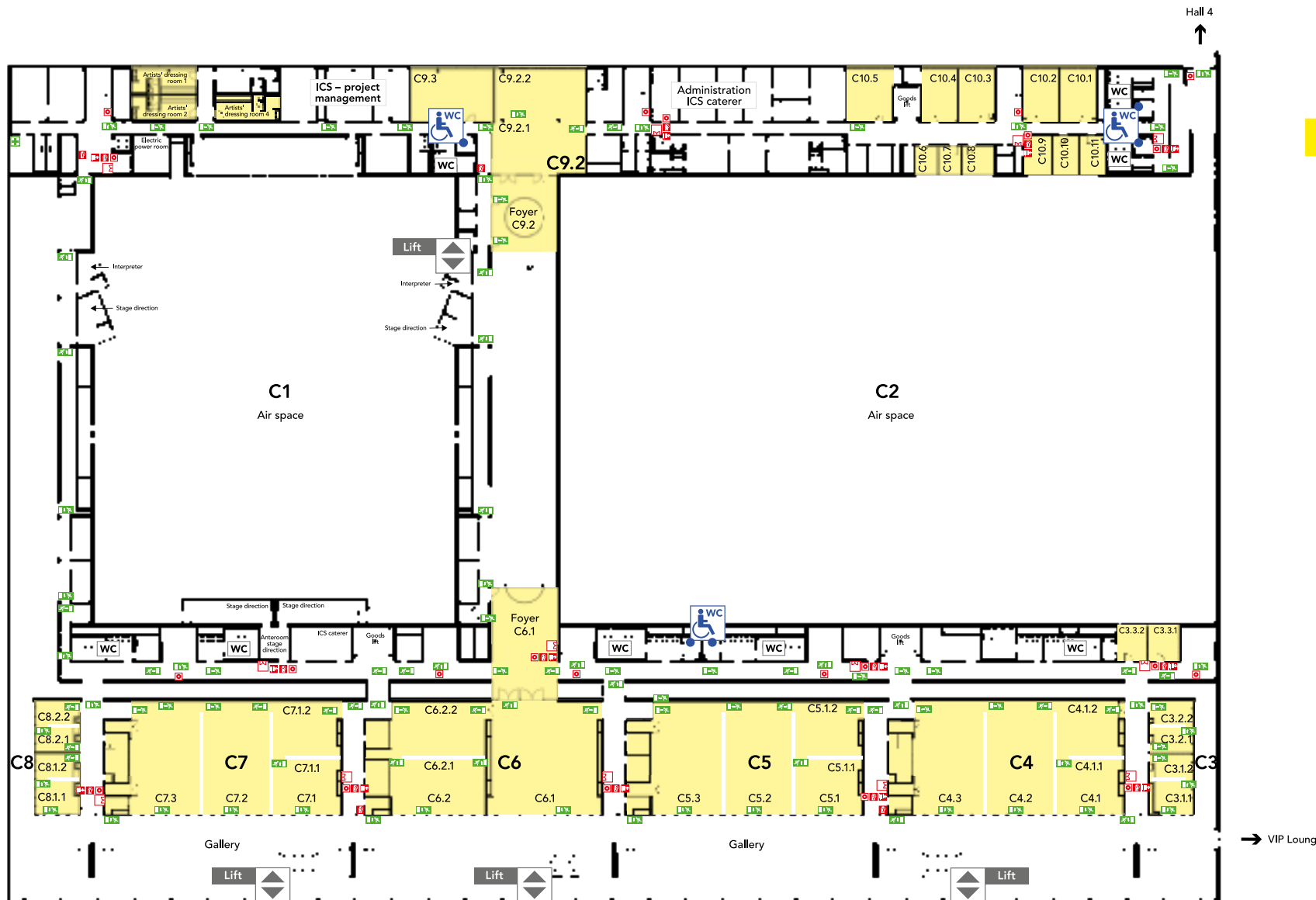

### Conference rooms

	m <sup>2</sup>	•••••	••	□	□
C4*	390	440	208	76	88
C5*	392	440	208	76	88
C6.1	205	200	96	40	52
C6.2*	175	180	80	36	48
C7*	393	440	208	76	88
C9.2*	165	173	80	34	38
C9.3	74	78	38	22	28

### Seminar and meeting rooms

C3.1*	42	32	12	12	16
C3.2*	34	28	12	12	16
C8.1*	41	28	12	12	16
C8.2*	35	28	12	12	16
C10	11-41				

Eleven more meeting rooms and offices are available in C10.

\*Rooms can be separated

The capacity figures above indicate the maximum number of guests permitted for the respective layout variant. The actual allowable capacity may be lower depending on the event concept at hand and the facilities required (technical equipment, assembled structures, etc).