

ICS Seminar room C9 - upper floor: Technical data



Size/dimensions/capacities

Internal dimensions Length x Width

- C9.2 12.50 m x 6.50 m
(can be divided) 12.00 m x 6.75 m
- C9.3 11.64 m x 6.75 m
- Foyer C9.2 8.75 m x 10.00 m
- Total floor space 492 m²
- Ceiling height/clearance height 2.58 m/2.52 m

Due to the flexible partition wall system the room C9.2 can be divided.

	m ²	●●●●	●●●●●	□□□□	□□
C9.2	165	173	80	34	38
C9.2.1	83	80	30	26	32
C9.2.2	83	88	38	22	32
C9.3	74	78	38	22	28
Foyer C9.2	87	--	--	--	--

Room specifications

- Barrier-free access
- Lighting: fluorescent lamps
- Daylight
- Control panel for room lighting/black-out option
- Black-out option with Venetian blinds
- Air-conditioning
- Type of floor
- Floor loading capacity
- Sound-insulated partition walls
- One side of room is glazed

carpet
500 kg/m²

Technical equipment and communication

- No fixed conference technology available.
- Telecommunication connections

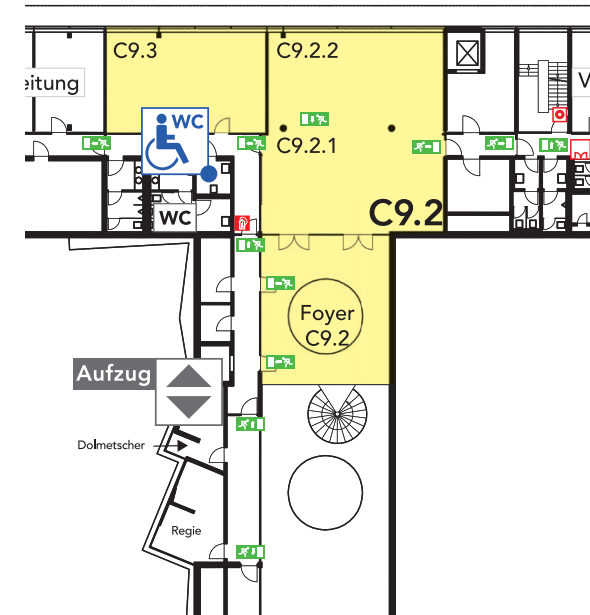

Delivery to rooms

- Access via the ICS foyer
- Delivery via the delivery areas of C1 or C2
- Transport to upper floor via two freight elevators, permitted weight up to 3,000 kg respectively 4,000 kg

